

REVIEWED FOR
CODE COMPLIANCE
BP-17-3412-CADD
501 SE 2ND ST
BLDG B

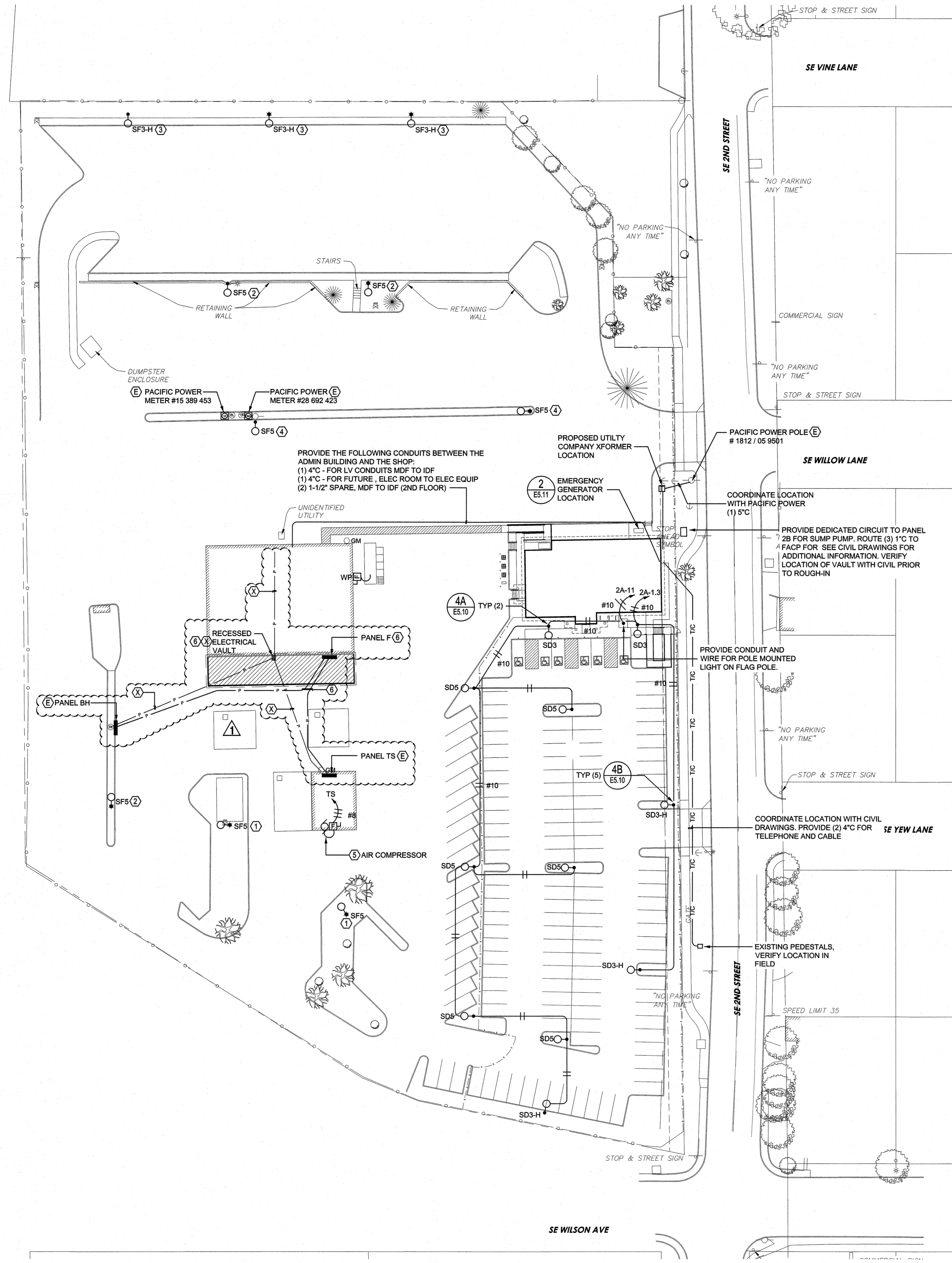
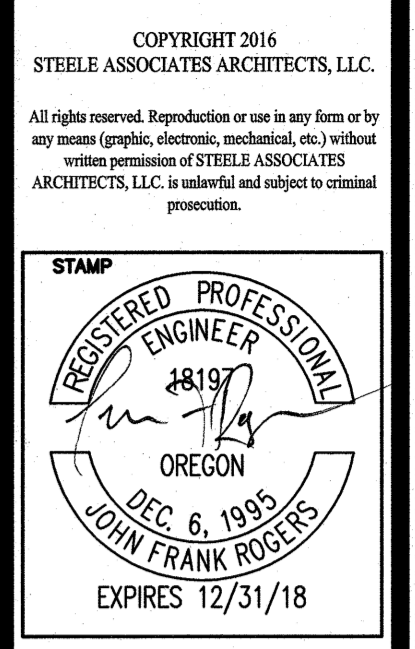

GENERAL NOTES:

1. SHADED ELECTRICAL IS DESIGNATED AS BEING PROVIDED UNDER SEPARATE PERMIT FOR ADMINISTRATION BUILDING.

SHEET NOTES:

1. REMOVE EXISTING LUMINAIRE ON EXISTING SQUARE POLE. PROVIDE NEW LUMINAIRE TYPE AS DESIGNATED, UTILIZE BRANCH CIRCUIT AND CONDUCTORS SERVING LOCATION. PROVIDE BLANK COVER POLE. ELECTRICAL CONTRACTOR IS RESPONSIBLE TO VERIFY POLE DIMENSIONS PRIOR TO ORDERING MOUNTING HARDWARE. COORDINATE MOUNTING HARDWARE WITH LUMINAIRE MANUFACTURER.
2. REMOVE EXISTING POST TOP LUMINAIRE ON EXISTING ROUND POLE. PROVIDE NEW LUMINAIRE TYPE AS DESIGNATED, UTILIZE BRANCH CIRCUIT AND CONDUCTORS SERVING LOCATION. ELECTRICAL CONTRACTOR IS RESPONSIBLE TO VERIFY POLE DIMENSIONS PRIOR TO ORDERING MOUNTING HARDWARE. COORDINATE MOUNTING HARDWARE WITH LUMINAIRE MANUFACTURER.
3. REMOVE EXISTING POST TOP FLOOD LUMINAIRE ON EXISTING ROUND POLE. PROVIDE NEW LUMINAIRE TYPE AS DESIGNATED, UTILIZE BRANCH CIRCUIT AND CONDUCTORS SERVING LOCATION. ELECTRICAL CONTRACTOR IS RESPONSIBLE TO VERIFY POLE DIMENSIONS PRIOR TO ORDERING MOUNTING HARDWARE. COORDINATE MOUNTING HARDWARE WITH LUMINAIRE MANUFACTURER.
4. REMOVE EXISTING LUMINAIRE ON EXISTING WOOD POLE. PROVIDE NEW LUMINAIRE TYPE AS DESIGNATED WITH NEW MAST ARM, UTILIZE BRANCH CIRCUIT AND CONDUCTORS SERVING LOCATION. ELECTRICAL CONTRACTOR IS RESPONSIBLE TO VERIFY EXISTING VOLTAGE AT POLE. COORDINATE MOUNTING HARDWARE WITH LUMINAIRE MANUFACTURER.
5. PROVIDE CONNECTION FOR RELOCATED AIR COMPRESSOR, INCLUDE ALL LABOR AND MATERIAL INCLUDING BUT NOT BE LIMITED TO DISCONNECT, CONDUIT, WIRE, AND SUPPORTS. VERIFY LINE OF SIGHT TO PANEL AND PROVIDE DISCONNECT AS REQUIRED BY NEC. PROVIDE NEW 40A-3P CIRCUIT BREAKER IN PANEL. VERIFY EXISTING CONNECTION TO AIR COMPRESSOR IN FIELD.
6. ELECTRICAL RECESSED VAULT WILL BE ABANDONED. THE FOLLOWING IS THE SEQUENCE OF WORK:
 - PROVIDE FEEDER FROM PANEL F TO PANEL BH, SEE ONE LINE. PROVIDE SEALOFFS BELOW PANEL (MIN 24" AFF)
 - PROVIDE FEEDER FROM PANEL F TO PANEL TS, SEE ONE LINE. PROVIDE SEALOFFS BELOW PANEL (MIN 24" AFF)
 - INSTALL ALL NEW CONDUITS & CONDUCTORS TO PANELS BH & TS ONCE PANEL F IS ENERGIZED THEN DISCONNECT EXISTING FEEDERS AND CONNECT NEW.
 - REMOVE EXISTING CONDUCTORS FROM EXISTING CONDUITS, CUT AND CAP AT FLOOR LEVEL.
 - REMOVE COVER OF VAULT AND FILL WITH BACKFILL AND CAP WITH CONCRETE. MINIMUM DEPTH TO MATCH NEW MAINTENANCE FLOOR.
 - CONNECT NEW FEEDERS COMPLETE TO PANELS.
 - COORDINATE DOWNTIME WITH MAINTENANCE FACILITY'S SCHEDULE TO MINIMIZE DOWNTIME OF PANELS.

1 SITE PLAN - ELECTRICAL
1" = 40' - 0"

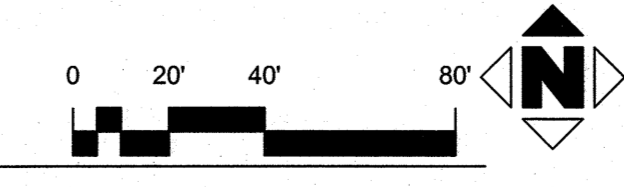

SYSTEM DESIGN CONSULTANTS INC.
333 SE SECOND AVE, SUITE 100
PORTLAND, OREGON 97214
503-248-0227 FAX 248-0240
CONTACT: JEFFREY DAVIS

BLS - TRANSPORTATION FACILITY 2017
501 SE 2ND STREET BEND, OR
SITE PLAN - ELECTRICAL

JOB NO.	16116.01
DATE	08/22/2017
DRAWN BY	JD
CHECKED BY	JFR
REVISIONS	DATE
CONFORMED SET	04/27/2017
	PR 007 07/14/2017
	PR 010 08/02/2017
CITY COMMENTS	08/22/2017

SHEET NO.
E1.10

CONFORMED SET