

**REVIEWED FOR  
CODE COMPLIANCE**  
BP-17-3412-CADD  
501 SE 2ND ST  
BLDG B

COPYRIGHT 2016  
STEELE ASSOCIATES ARCHITECTS, LLC.  
All rights reserved. Reproduction or use in any form or by  
any means (graphic, electronic, mechanical, etc.) without  
written permission of STEELE ASSOCIATES  
ARCHITECTS, LLC. is unlawful and subject to criminal  
prosecution.



DEMO KEYNOTES

- APPROXIMATE EXTENT OF EXISTING HARD SURFACE (ASPHALT, CONCRETE, ETC.) REMOVAL. VERIFY EXTENTS WITH SITE PLAN(S) & EXISTING CONDITIONS. - SEE CIVIL DRAWINGS

**STEELE ASSOCIATES**  
ARCHITECTS LLC  
686 NW YORK DRIVE #150  
541.382.9867 FAX 541.385.8816  
BEND, OR 97703  
info@steele-arch.com

GENERAL NOTES

- REFER TO GENERAL NOTES ON SHEET G0.1B
- HAZARDOUS MATERIAL ABATEMENT BY OTHERS. COORDINATE WORK WITH OWNER
- REFER TO SPECIFICATION SECTIONS 02 4100 AND 02 6500 FOR ADDITIONAL INFORMATION RELATED TO DEMOLITION

LEGEND

APPROXIMATE EXTENT OF HARD SURFACE REMOVAL. SEE CIVIL

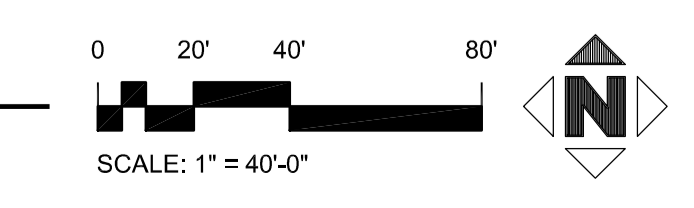
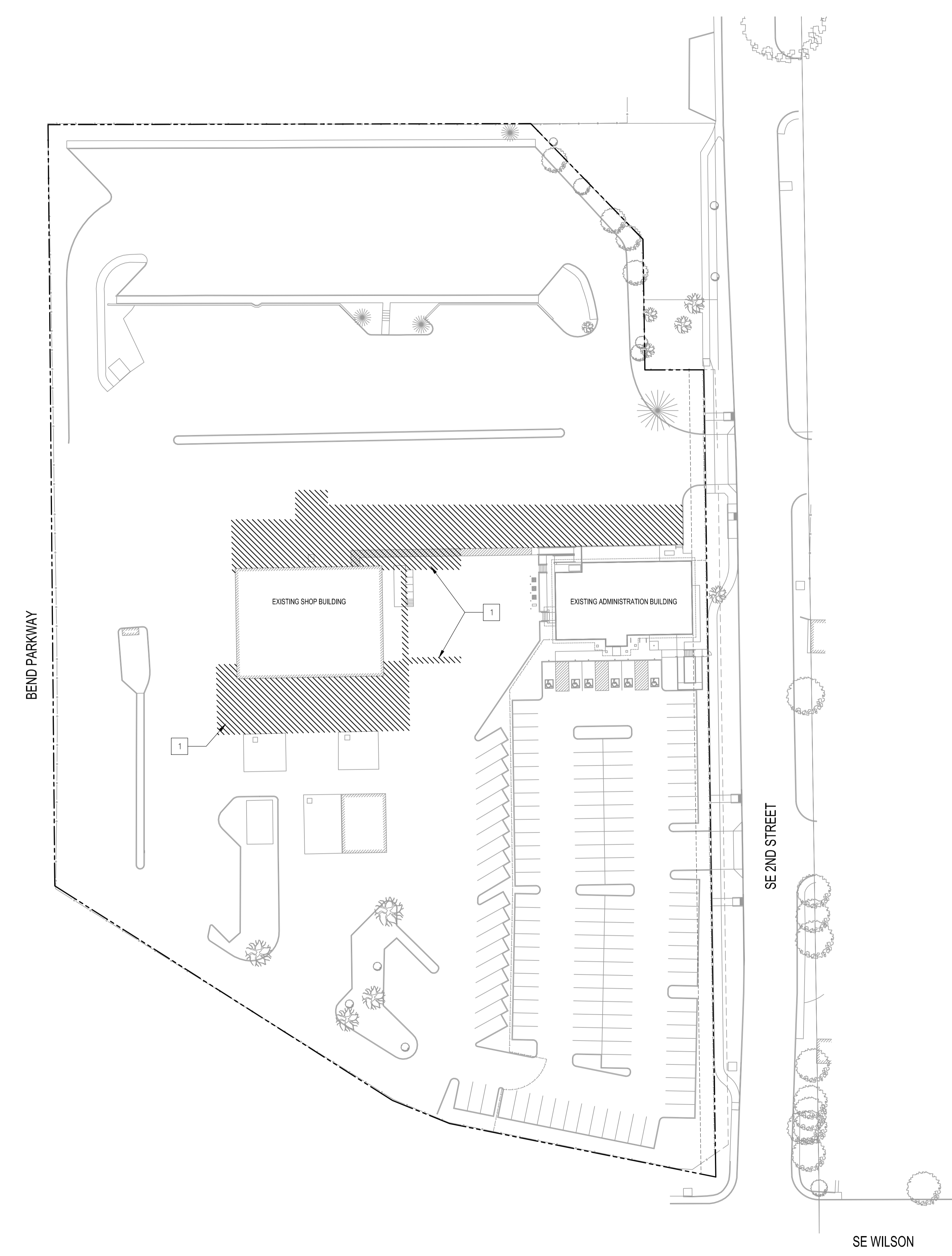

1 SHOP BUILDING DEMOLITION SITE PLAN

BLS - TRANSPORTATION FACILITY 2017  
501 SE 2ND STREET BEND, OR.  
**SHOP BUILDING SITE DEMOLITION  
PLAN**

JOB NO.	16116.01
DATE	7/10/2017
DRAWN BY	AL
CHECKED BY	DAO/STS
REVISIONS	DATE
	PERMIT SET 07/14/2017

SHEET NO.  
**AD1.11**

PERMIT SET

7/12/2017 4:24 PM 16116.01 BLDG Maintenance Facility (020) BLS - Maintenance Facility 2017 (User:AO/11) Shop Building Site Demolition Plan.dwg