

**REVIEWED FOR
CODE COMPLIANCE**
BP-17-3412-CADD
501 SE 2ND ST
BLDG B

COPYRIGHT 2016
STEELE ASSOCIATES ARCHITECTS, LLC.
All rights reserved. Reproduction or use in any form or by
any means (graphic, electronic, mechanical, etc.) without
written permission of STEELE ASSOCIATES
ARCHITECTS, LLC. is unlawful and subject to criminal
prosecution.

STAMP
REGISTERED ARCHITECT
3315
SCOTT T. STEELE
BEND, OREGON
STATE OF OREGON

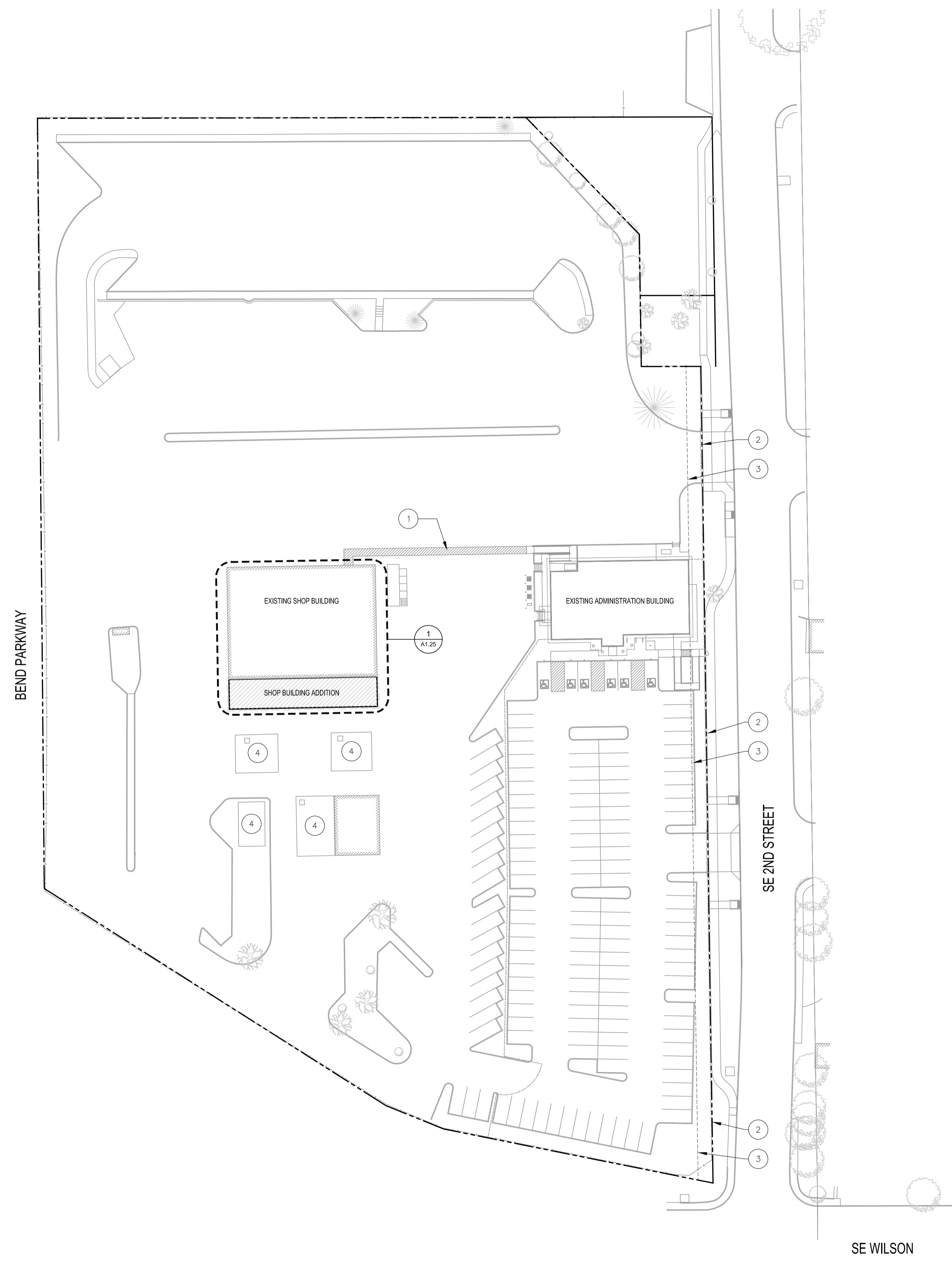

- ### KEYNOTES
1. ACCESSIBLE ROUTE (COMPLETED UNDER SEPARATE PERMIT)
 2. REVISED PROPERTY LINE PER 10'-0" DEDICATION. SEE CIVIL DRAWINGS
 3. 10'-0" SETBACK LINE
 4. EXISTING CONCRETE PAD TO REMAIN, TYPICAL UNLESS NOTED OTHERWISE

- ### GENERAL NOTES
- A. REFER TO GENERAL NOTES ON SHEET G0.1B
 - B. SEE SPECIFICATION DIVISIONS 31, 32, 33, & CIVIL DRAWINGS FOR ADDITIONAL SITE RELATED INFORMATION.

1 SHOP BUILDING ARCHITECTURAL SITE PLAN

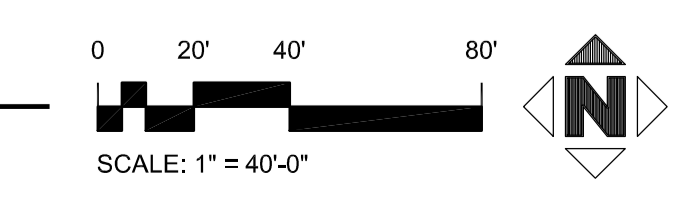

STEELE ASSOCIATES
ARCHITECTS LLC
686 NW YORK DRIVE #150
541.382.9867 FAX 541.385.8816
BEND, OR 97703
info@steele-arch.com

BLS - TRANSPORTATION FACILITY 2017
501 SE 2ND STREET BEND, OR.
**SHOP BUILDING ARCHITECTURAL SITE
PLAN**

JOB NO.	16116.01
DATE	7/10/2017
DRAWN BY	AL
CHECKED BY	DAO/SJS
REVISIONS	DATE
PERMIT SET	07/14/2017

SHEET NO.
A1.11

PERMIT SET

7/12/2017 4:58 PM 16116.01 E:\00\projects\16116.01 BLS Transportation Facility\2017\Drawings\A1.11 Shop Building Architectural Site Plan.dwg